



Kentucky Extension Homemakers Association
 92nd Annual Meeting
 May 12-14, 2026
 Hyatt Regency
 Lexington, KY



2026 SCHEDULE AT A GLANCE

All events take place at the Hyatt Regency. All times are Eastern Time.

TUESDAY, MAY 12

8:00 a – 10:30 a Trade Show Set up
 KEHA Showcase Check-In
 Silent Auction Check-In
 Basket Raffle Check-In

8:00 a – 5:00 p Registration
 Voting Delegate Sign-In

8:30 a – 11:00 a Cultural Arts Check-In

8:30 a – 11:30 a Quilt Square Auction Check-In

9:00 a – 5:00 p CCK Quilt Donations

9:30 a – 11:15 a Leadership Academy Lounge

10:30 a – 5:30 p Trade Show Opens
 Basket Raffle, Silent Auction
 Showcase Opens

**11:30 a – 1:30 p OPENING LUNCHEON
 Patterson Ballroom**

1:45 p – 3:00 p Seminars – Session 1

1:45 p – 5:30 p Quilt Square Auction Bidding

3:30 p – 4:45 p Seminars – Session 2

5:15 p – 6:15 p Hands-on Creative Classes 1

6:15 p or later DINNER ON YOUR OWN

WEDNESDAY, MAY 13

8:00 a - 9:45 a Registration
 Voting Delegate Sign-In
 Quilt Square Auction Bidding
 Basket Raffle, Silent Auction
 CCK Quilt Donations

8:00 a – 2:30 p Cultural Arts Viewing

8:00 a - 5:00 p Trade Show
 Showcase

8:15 a - 9:30 a Seminars - Session 3

10:00 a - 11:30 a

**BUSINESS MEETING
 Patterson Ballroom**

11:30 a - 1:15 p

Quilt Square Auction Bidding
 Basket Raffle, Silent Auction

11:30 a – 1:15 p

VSU Lounge

11:30 a - 4:00 p

Registration

11:30 a - 1:15 p

**MFHG LUNCHEON
 (separate registration)
 Kentucky Room**

11:30 a - 1:30 p

LUNCH ON YOUR OWN

1:30 p - 2:45 p

Seminars - Session 4

1:30 p - 3:00 p

Master Farm Homemaker Guild
 Business Meeting

3:15 p - 4:15 p

Hands-On Creative Classes 2

4:00 p - 5:00 p

Quilt Square Auction Pick-Up/Pay
 Silent Auction Pick-Up/Pay
 Showcase Display Pick-Up

4:00 p - 5:00 p

Cultural Arts Check-Out

5:00 p – 6:00 p

**GENERAL SESSION with
 KEHA Choir Performance
 Patterson Ballroom**

6:00 p or later

DINNER ON YOUR OWN

THURSDAY, MAY 14

7:30 a - 8:30 a

Registration

8:00 a - 9:15 a

Officer Training Workshops

9:45 a - 11:00 a

Educational Chair Trainings

11:30 a – 1:30 p

**AWARDS LUNCHEON
 Patterson Ballroom**

HOTEL DIAGRAM

Mezzanine Level / 2nd Floor



Lobby Level / Ground Floor

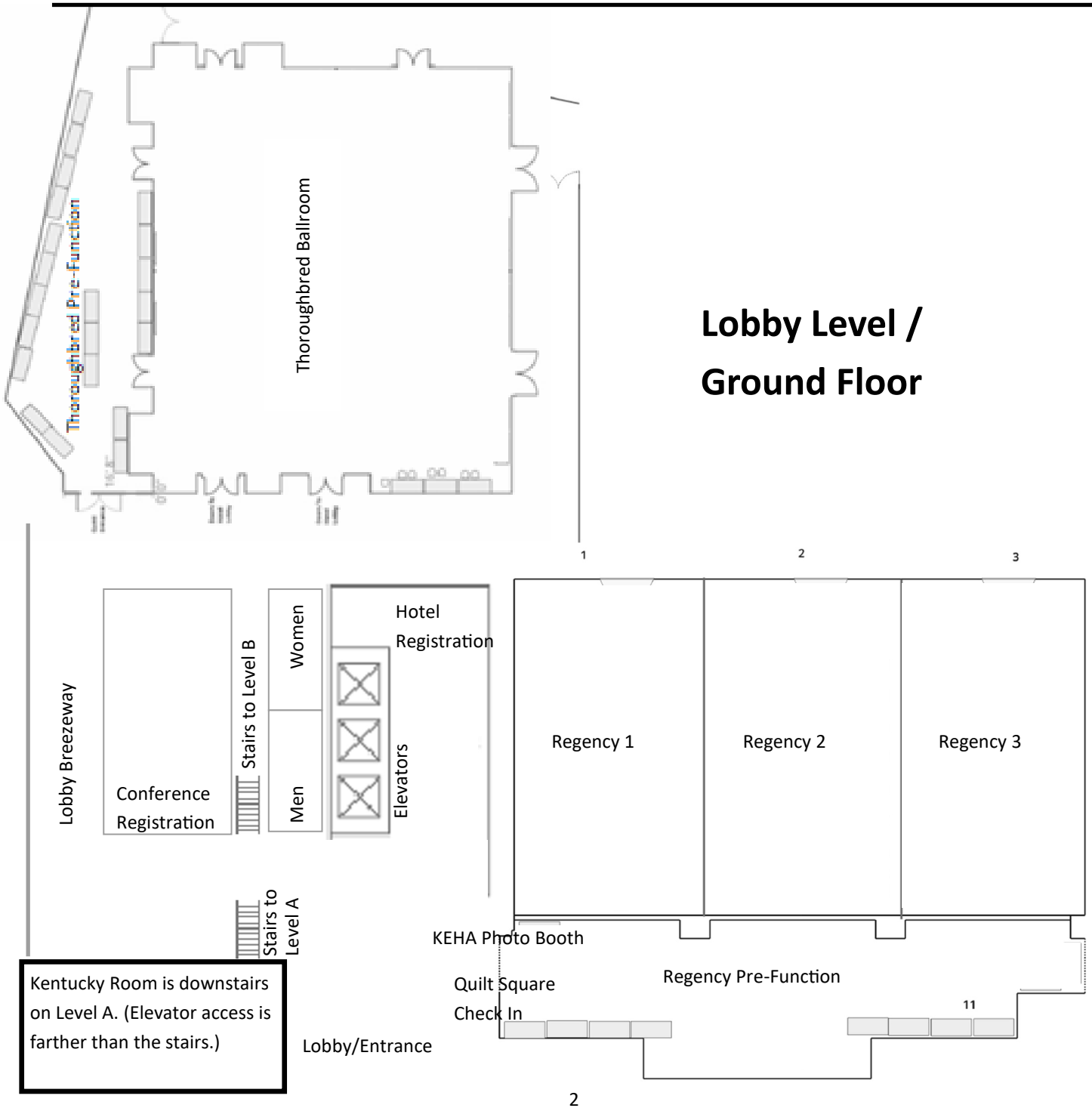

GENERAL INFORMATION

NOTE: Please silence all cell phones and electronic devices during sessions. Thank you!

STATE MEETING REGISTRATION—Lobby Level

Monday 5 p.m. to 6 p.m. ET
 Tuesday 8 a.m. to 5 p.m.
 Wednesday 8 a.m. to 9:45 a.m. & 11:30 a.m. to 4 p.m.
 Thursday 7:30 a.m. to 8:30 a.m.

VOTING DELEGATE SIGN-IN—Lower Level B

Tuesday 8 a.m. to 5 p.m. ET
 Wednesday 8 a.m. to 9:45 a.m.
 Voting delegates must sign-in and pick up their delegate information packet prior to the Business Meeting. Please plan to be registered at least a half hour before start and in your seat 10 minutes prior to the start of the meeting.

T-SHIRT PICK-UP

The T-shirt pick-up will be in Patterson H, the board room next to the restrooms on Lower Level B.

WIRELESS INTERNET

The Hyatt offers complimentary Wifi.
 Network: Hyatt Conference Wifi (no password)

Q&A OPPORTUNITY

Visit our new Q&A Lounges in the Henry Clay Boardroom:
Leadership Academy Tuesday 5/12 from 9:30-11:15 a.m. – For all graduates AND future candidates.
Volunteer Service Unit (VSU) Wednesday 5/13 from 11:30 a.m. to 1:15 p.m.—Get answers to your questions!

RESTAURANT OPTIONS

For those meals that are “on your own” you may consider the hotel dining room or look up the many local dining options at <https://bit.ly/FoodLex> or by using the QR code. The hotel dining room will be open for lunch on Wednesday this year.



HOTEL DIAGRAM

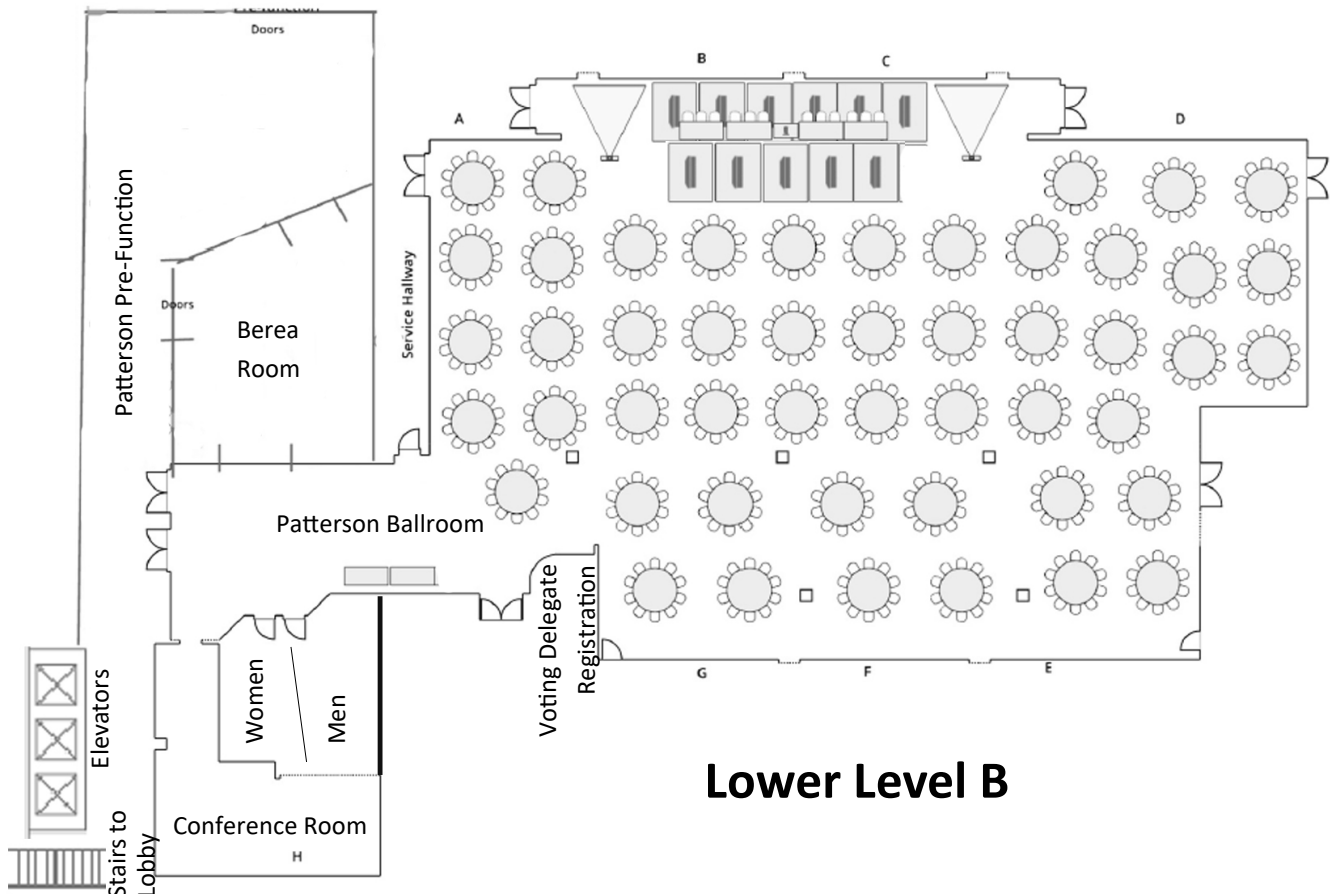

Lower Level B

GENERAL INFORMATION

BASKET RAFFLE & SILENT AUCTION

The raffle and auction will be in the Thoroughbred Pre-Function on the lobby level. Purchase raffle tickets to enter to win themed **gift baskets** provided by each area. Raffle proceeds will benefit Ovarian Cancer Research. Bid on **silent auction** items donated by counties and individuals, with proceeds to benefit the 4-H Foundation.

Check-In: Tuesday 8-10:30 a.m. ET
 Bidding: Tuesday 10:30 a.m. to 5:30 p.m.
 Bidding: Wednesday 8-9:45 a.m. & 11:30 a.m.-1:15 p.m.

NOTE: Bidding is CLOSED during the Business Meeting.

Auction Pick-Up/Pay: Wednesday 4-5 p.m. Raffle baskets will be awarded during the Wednesday general session.

NOTE: Winning TICKET must be presented to collect prize in person. (The winning person does not have to be present, but someone must turn in the ticket to collect.)

KEHA SHOWCASES

Showcases will be in the Regency Pre-Function on the lobby level from 10:30 a.m. to 5:30 p.m. Tuesday and from 8 a.m. to 5 p.m. Wednesday. Display pick-up is 4-5 p.m. Wednesday.

Showcases may feature area, educational chairperson, and KEHA grant winner activities. Come see what KEHA members have been doing!

QUILT SQUARE AUCTION AND SHOWCASE

Bid on these beautiful 12-inch finished quilt squares and vote for your favorite! The display is in the Main Lobby Breezeway near KEHA registration. Proceeds this year will help offset the costs associated with KEHA State Meeting.

Check-In: Tuesday 8:30-11:30 a.m. ET (hotel lobby)
 Bidding/Voting: Tuesday 1:45-5:30 p.m.
 Bidding/Voting: Wednesday 8-9:45 a.m. & 11:30 a.m.-1:15 p.m.
 Pick-Up/Pay: Wednesday 4-5 p.m.

CENTER FOR COURAGEOUS KIDS (CCK) QUILT COLLECTION POINT

The Center for Courageous Kids in Scottsville, Ky., needs new twin bed quilts, approximately 66" by 83" either homemade or store bought. Drop off at the Center in Scottsville or bring to KEHA State Meeting's collection point at KEHA registration in the lobby. Tuesday 9 a.m.-5 p.m. & Wednesday 8-9:45 a.m. & 11:30 a.m.-4 p.m.

CULTURAL ARTS

Check-In is Tuesday 8:30-11 a.m. ET

CHECK-IN	KEHA AREAS
8:30 a.m.	Bluegrass, Fort Harrod
9:00 a.m.	Licking River, Louisville, Northern KY
9:30 a.m.	Northeast, Quicksand, Wilderness Trail
10:00 a.m.	Lake Cumberland, Lincoln Trail, Mammoth Cave
10:30 a.m.	Green River, Pennyryle, Purchase

This year, the Cultural Arts Exhibit will take place in the Thoroughbred Ballroom on the lobby level. Check-in is from 8:30-11 a.m. Tuesday. After check-in the room is locked for judging for the rest of Tuesday.

The display will be open for viewing for registered attendees from 8 a.m. to 2:30 p.m. on Wednesday. Viewers may vote for a "Viewer's Choice." To protect the entries, no food or drink is allowed in the Exhibit Hall. Item check out is from 4-5 p.m. Wednesday.

Check-Out is Wednesday 4-5 p.m. ET

CHECK-OUT	KEHA AREAS
Opens at 4:00 p.m. for these Areas	Green River, Lake Cumberland, Lincoln Trail, Mammoth Cave, Pennyryle, Purchase, Wilderness Trail
Opens at 4:30 p.m. for these Areas	Bluegrass, Fort Harrod, Licking River, Louisville, Northeast, Northern Kentucky, Quicksand

Thank you!

Thank you to KEHA State Cultural Arts & Heritage Chair Cindy Moore, her Advisor Jeanne Badgett, and the many volunteers who make this display happen! This year, four areas were assigned to help host the exhibit: Louisville, Mammoth Cave, Pennyryle, and Purchase.

TUESDAY, MAY 12, 2026

Opening Luncheon in Patterson Ballroom— Level B 11:30 a.m.– 1:30 p.m.

Presiding
Henrietta Sheffel, KEHA President

Inspirational Thought
Karen Hill, Parliamentarian

LUNCH

Greetings and Welcome to the 2026 KEHA State Meeting
Connie Vaughn, Bluegrass Area President

Greetings from FCS Extension
Dr. Heather Norman-Burgdolf, Assistant Director,
Family and Consumer Sciences Extension,
UK Martin-Gatton College of Agriculture, Food and Environment

Introduction of KEHA Past Presidents
Henrietta Sheffel, KEHA President

Introduction of Keynote Speaker
Ann Porter, KEHA 1st Vice President

Keynote Speaker: Amber Philpott

Award-winning news anchor with WKYT TV in Lexington

Ovarian Cancer Fund Presentations
Esther Bailey, KEHA Food, Nutrition, and Health Chairperson

Accepting Presentation of Donation
Edward J. Pavlik, Ph.D., Professor, Division of Gynecologic Oncology,
University of Kentucky Medical Center

Announcements
Henrietta Sheffel, KEHA President

OVARIAN CANCER AWARDS

Counties with largest donations per member:

1st Place – Muhlenberg County, \$67.17
2nd Place – Carroll County, \$38.52
3rd Place – Taylor County, \$29.81

Counties with largest overall donations:

1st Place – Taylor County, \$9,300.00
2nd Place – Mason County, \$7,782.75
3rd Place – Muhlenberg County,
\$6,784.00

Counties contributing over \$1,000:

Barren	Kenton	Mason
Carroll	Lincoln	Muhlenberg
Hardin	Madison	Taylor

One-Time Donations of More than \$500:

Sew Fun Quilting Homemakers,
Mammoth Cave \$1,205.00
Bluegrass Area Homemakers \$1,141.00
Louisville Area Homemakers \$926.00

County with largest number of first-time ovarian cancer screening participants:

1st Place – Knox, 12
2nd Place – Mason, 7
3rd Place (tie) – Bourbon, 5
3rd Place (tie) – Green, 5

Ovarian Cancer Fundraising Contest

1st Place – Mason County, Ann Porter
2nd Place – Taylor County, Debbie Holt
3rd Place – Barren County, Cynthia Rowland

OVARIAN CANCER AWARDS

Counties with 100% donations to Ovarian Cancer Research: (*Denotes counties with over 100% donations.)

<u>Bluegrass</u>	<u>Fort Harrod</u>	<u>Pennyryle</u>	<u>Lake Cumberland</u>	<u>Mammoth Cave</u>	<u>Licking River</u>	<u>Northeast</u>
Bourbon	Anderson*	Caldwell*	Adair	Allen*	Bath	Boyd*
Clark	Boyle	Christian	Clinton	Barren*	Fleming	Carter
Estill	Franklin*	Crittenden*	Cumberland	Butler	Lewis*	Floyd*
Fayette*	Garrard	Hopkins	Green	Edmonson	Mason*	Greenup*
Harrison*	Jessamine*	Livingston*	McCreary	Logan	Menefee	Johnson
Madison*	Lincoln*	Lyon	Pulaski	Metcalfe	Montgomery	Lawrence*
Nicholas	Mercer*	Muhlenberg*	Russell	Monroe*	Morgan	Martin*
Scott	Woodford	Todd	Taylor*	Simpson	Rowan	Pike*
		Trigg	Wayne*	Warren*		
<u>Lincoln Trail</u>	<u>Northern Kentucky</u>	<u>Louisville</u>	<u>Green River</u>	<u>Purchase</u>	<u>Quicksand</u>	<u>Wilderness Trail</u>
Breckinridge	Boone*	Bullitt	Hancock	Ballard	Breathitt	Bell
Grayson	Campbell	Jefferson*	Henderson	Carlisle	Knott	Clay
Hardin*	Carroll*	Oldham	McLean *	Fulton*	Leslie	Harlan
LaRue*	Gallatin	Shelby*	Ohio	Graves	Letcher	Knox
Marion	Grant	Spencer		Hickman	Perry*	Laurel*
Meade*	Kenton*	Trimble		Marshall		Rockcastle
Nelson*	Owen			McCracken*		Whitley
Washington						

TUESDAY, MAY 12, 2026

Seminars – Session 1 1:45–3:00 p.m. ET

Homemade, Healthy & Delicious
Regency 1—Lobby Level
Victoria Faoro

**Leading with Understanding: the Power of Personality
in Extension Leadership**
Regency 2—Lobby Level
Cindy Jenkins, Utah State University Extension

Same Scams, New Tricks
Regency 3—Lobby Level
Rick Sellnow

**Colors of the Mountains: Exploring Appalachian Dyes
Kentucky—Lower Level A**
Sarah Congleton, Cheyenne Lamb, Aggie Fink

There's Strength in Every Story
Berea—Lower Level B
Dot Dunn Hart, NVON Vice President

Block Party: Paint Your Own Mini Barn Quilt
Woodford—2nd Floor
Kimberly Thomas

Starting a Book Club! How Do You Begin?
Franklin/Scott—2nd Floor
Jody Paver, Callie Wallin, Babette Overman, Sherri
Martin, Jennifer Stewart, Renate Mason, Donna Furnas

Supporting Breastfeeding in Our Communities
Jessamine—2nd Floor
Courtney Luecking, Martha Colley, Gracie Watkins,
Jeanne Badgett

UK Downtown Studio Walking Tour
*Meet in the hallway between the Lobby Breezeway and
the Thoroughbred Pre-Function*
Megan Sizemore—College of Communications

Seminars – Session 2 3:30–4:45 p.m. ET

Backyard Gardening for Butterflies, Birds & Bees
Regency 1—Lobby Level
Victoria Faoro

**Leading with Understanding: the Power of Personality
in Extension Leadership**
Regency 2—Lobby Level
Cindy Jenkins, Utah State University Extension

Understanding AI (Artificial Intelligence)
Regency 3—Lobby Level
Rick Sellnow

**Colors of the Mountains: Exploring Appalachian Dyes
Kentucky—Lower Level A**
Sarah Congleton, Cheyenne Lamb, Aggie Fink

From Memories to Memoirs
Berea—Lower Level B
Carol June Franks of Junebug Tales Publishing

**No-Sew Upcycling T-shirt Bag: Get Creative Without the
Needle**
Woodford—2nd Floor
Lorie Adams, Charlinda Fugate, Anita Noble

Award Winning Community Service Projects
Franklin/Scott—2nd Floor
Sharon Wood, Danica Porter, and the Fern Leaf
Homemakers (Taylor and Mason Counties)

I Want to Weave a Basket - Where Do I Go?
Jessamine—2nd Floor
Kay Kass

UK Downtown Studio Walking Tour
*Meet in the hallway between the Lobby Breezeway and
the Thoroughbred Pre-Function*
Megan Sizemore—College of Communications

Hands-on Creative Classes 1 5:15–6:15 p.m. ET

- | | | |
|---|--|--|
| ◆ Patriotic Pin
Regency 1—Lobby Level | ◆ Fun Folded Birthday Cards
Regency 3 —Lobby Level | ◆ Starburst Cardboard Craft
Woodford—2nd Floor |
| ◆ Holiday Ornaments—Snowflake
& Reindeer
Regency 2 —Lobby Level | ◆ Felt Flag Flower
Kentucky—Lower Level A | ◆ Denim Flower
Franklin/Scott—2nd Floor |
| | ◆ Flower Pin Cushion
Berea—Lower Level B | ◆ Spice It Up!
Jessamine—2nd Floor |

WEDNESDAY, MAY 13, 2026

Seminars - Session 3 8:15—9:30 a.m. ET

Eat Well, Live Well: The Mediterranean Diet Approach
Regency 1—Lobby Level
Heather Norman-Burgdolf, Anna Cason, Gracie Watkins

Volunteerism 2026: Preparing for a New Breed of Volunteer
Regency 2—Lobby Level
Ken Culp III

Understanding AI (Artificial Intelligence)
Regency 3—Lobby Level
Rick Sellnow

Gardening Safely
Kentucky—Lower Level A
Danielle Hagler

Disasters Don't Stand a Chance: A Preparedness Game
Berea—Lower Level B
Andrea Higdon, Geri Zakharia

Block Party: Paint Your Own Mini Barn Quilt
Woodford—2nd Floor
Kimberly Thomas

KEHA History and Reflections
Franklin/Scott—2nd Floor
Kim Henken, Martha Nall

The Wool Story: A Complete Journey from Shearing to Stitching and Fleece to Fashion
Jessamine—2nd Floor
Phillip & Sheryl Morgan, Cindy Moore, Krista Perry

UK Downtown Studio Walking Tour
Meet in the hallway between the Lobby Breezeway and the Thoroughbred Pre-Function
Megan Sizemore—College of Communications

Business Meeting in Patterson Ballroom—Level B 10:00—11:30 a.m. Reserved seating for voting delegates

Business Meeting Note:
Voting delegates should be in their seats at least 10 minutes prior to meeting start, and everyone is asked to arrive in a timely fashion so the meeting can start on time. Please silence cell phones. Raffle/Auction bidding is CLOSED during the Business Meeting.

Inspiration
Pledge to the Flag
Call to Order
Roll Call Committee Report
Adoption of Rules of Convention
2025 Minutes
Treasurer's Report
Audit Committee Report
Nominating Committee Report
Election of Officers and Chairpersons
Bylaws Committee Report
2026 Leadership Academy Report
2026-2027 Proposed Budgets
President's Report
Other Business
Announcements
Adjourn

LUNCH ON YOUR OWN (suggestions on page 3)
Or

Master Farm Homemakers Guild Luncheon (separate registration)

EVERYONE registered is welcome to attend. This meeting is open to all the KEHA membership. Please be in the room prior to meeting start. Silence cell phones and please stay seated throughout the meeting.

Master Farm Homemakers Guild (MFHG) Luncheon and Meeting Kentucky Room—Lower Level A

MFHG Luncheon (separate registration)
11:30 a.m.—1:15 p.m.
MFHG Business Meeting
1:30 p.m.—3:00 p.m.



WEDNESDAY, MAY 13, 2026

Seminars - Session 4
1:30–2:45 p.m. ET

Special Gifts for Special People
Regency 1—Lobby Level
Cindy Williams

Somewhere Over the Rainbow: Interpreting the Wizard of Oz
Regency 2—Lobby Level
Ken Culp III

The Basics of Sourdough
Regency 3—Lobby Level
Megan Gullett, Kimberly Hope-Thomas, Leah VanMeter Cardwell

Time Well Spent
Berea—Lower Level B
Danielle Hagler

Parli Like a Pro: Tips for Meeting Participants
Woodford—2nd Floor
Kim Henken, Karen Hill

Prepared for Whatever the Season Might Bring: A Home Preparation Guide
Franklin/Scott—2nd Floor
Monica Mundy

CASA Advocacy and Kentucky's Children
Jessamine—2nd Floor
Courtney Williams

UK Downtown Studio Walking Tour
Meet in the hallway between the Lobby Breezeway and the Thoroughbred Pre-Function
Megan Sizemore—College of Communications

KEHA Choir Rehearsal
Patterson Ballroom—Level B
Wendy Hood



A special **thank you** goes to all those who helped make the 2026 KEHA State Meeting a success ~

to the Bluegrass Area Host Committee, and Connie Vaughn, Bluegrass Area President;

to each of the 14 areas for fulfilling their assigned responsibilities;

to the KEHA Executive Committee and Educational Chairpeople;

to the Extension agents, specialists, and all presenters of learning sessions;

and to the KEHA Choir and all of our speakers ~

thank you for sharing your time and talent.

Hands-on Creative Classes 2
3:15–4:15 p.m. ET

◆ **Patriotic Pin**
Regency 1—Lobby Level

◆ **Basket with Beaded Rim**
Regency 2 —Lobby Level

◆ **Fun Folded Birthday Cards**
Regency 3 —Lobby Level

◆ **Felt Flag Flower**
Kentucky—Lower Level A

◆ **Flower Pin Cushion**
Berea—Lower Level B

◆ **Starburst Cardboard Craft**
Woodford—2nd Floor

◆ **Denim Flower**
Franklin/Scott—2nd Floor

◆ **Spice It Up!**
Jessamine—2nd Floor

WEDNESDAY, MAY 13, 2026

General Session with KEHA Choir in Patterson Ballroom—Level B 5:00–6:00 p.m.

Presiding

Patsy Kinman, KEHA Treasurer

Inspirational Thought

Esther Bailey, Food, Nutrition & Health Chairperson

KEHA New Website “Unveiling”

Sharon Fields, Marketing & Publicity Chairperson

Greetings from the Dean (video)

Dr. Laura Stephenson, Dean of the

UK Martin-Gatton College of Agriculture, Food and Environment
and Vice President of Land-Grant Engagement

Greetings

Kelly May, KEHA State Advisor

Susan Hansford, President, Kentucky Master Farm Homemakers Guild

KEHA Choir Performance

Wendy Hood, KEHA Choir Director

Cultural Arts—Viewer’s Choice Winner

Cindy Moore, KEHA Cultural Arts & Heritage Chairperson

Quilt Square Auction—Viewer’s Choice Winner

Anita Noble, Quicksand Area President

DeRhonda Hubbs, Wilderness Trail Area President

Announcements

Patsy Kinman, KEHA Treasurer

Drawing of Raffle Basket Winners

Mary Lynn Chaudoin, Lake Cumberland Area President

DINNER ON YOUR OWN

Winner, National Home Demonstration Council Song Contest, September, 1956

Ever Onward

Words by Dorothy D. Bullock
of Kentucky and Music by Max Exner

Like the music of a mighty band
Our voices ring across the land
Singing of duty nobly done
While we advance as one!

**Onward, ever onward with a
strength born of unity
To our God, our home, and country
we will pledge our loyalty**

Armed with faith and zeal throughout
our days
We’ll keep the heart of home ablaze
Striving for better ways to live
Living to serve and give!

**Onward, ever onward with a
strength born of unity
To our God, our home, and country
we will pledge our loyalty**

Let us make each home a beacon light
To guide our nation’s course a-right
Spreading with gentle heart and hand
Peace over all the land!

**Onward, ever onward with a
strength born of unity
To our God, our home, and country
we will pledge our loyalty**

2026 KEHA Choir

Directed by Wendy Hood, Mercer County



Elizabeth Collins, Franklin
Connie Conley, Marshall
Kathy Diaz, Lincoln
Aggie Fink, Montgomery
Teresa Goggin, Boyle
L.J. Harville, Pike (soloist)
Wendy Hood, Mercer
Judy Jackson, Grant
Sue Linnenkohl, Campbell
Flo McDonald, Pendleton
Linda Mitchell, Marshall

Diana Morgan, Grant
Samantha Page, Montgomery
Glenna Peterson, Fleming
Marilyn Powell, Mercer
Jennifer Spriggs, Boone
Hannah Sturgill, Woodford (FCS Agent)
Sharon Taylor-Carillo, Simpson
Diane Williams, Menifee
Lorraine Williams, Grant
Rita Yates, Washington
Louise Zachary, Nicholas



Officer Trainings

8:00 a.m.-9:15 a.m. ET

President

Thoroughbred Ballroom—Lobby Level

Henrietta Sheffel, President

Vice President

Regency 1—Lobby Level

Ann Porter, 1st Vice President

Martha Colley, 2nd Vice President

Treasurer

Regency 3—Lobby Level

Patsy Kinman, Treasurer

Secretary

Franklin/Scott—2nd Floor

Barbara Seiter, Secretary

Educational Chair Trainings

9:45.-11:00 a.m. ET

Leadership Development

Thoroughbred Ballroom—Lobby Level

Chair Cyndy Humble and Advisor Sally Mineer

International

Regency 1—Lobby Level

Chair Tammy Alford and Advisor Leslie Frame

Cultural Arts & Heritage

Regency 2—Lobby Level

Chair Cindy Moore and Advisor Jeanne Badgett

Management & Safety

Regency 3—Lobby Level

Chair Diana Morgan and Advisor Dr. Monica Mundy

Family & Individual Development

Kentucky—Lower Level A

Chair Amelia Godfrey and Advisor Dr. Natese Dockery

Food, Nutrition & Health

Berea—Lower Level B

Chair Esther Bailey and Advisor Dr. Heather Norman-Burgdolf

Environment, Housing & Energy

Woodford—2nd Floor

Chair Rhonella Chaffin and Advisor Tyrone Atkinson

4-H Youth Development

Franklin/Scott—2nd Floor

Chair Peggy Tracy and Advisor Dr. Kim Schrader

Kentucky Homemaker Creed

I believe in the home
as an inspiring and happy center of family
life - comfortable and attractive - a place
for relaxation and work
where pleasures and responsibilities are
shared.

I believe in the home and its contribution
to community life
which reflects the development of the
homemaker and the family.
I believe in the homemaker - alert, diligent,
in search of better ways
of doing ordinary things for the welfare and
happiness of the family.

I believe in the homemaker as a
community leader responsible for
passing on to others mastered skills and
knowledge.

I believe in the fellowship that comes
through the homemakers organization -
the exchange of ideas and the joy of
knowledge shared with others,
thus broadening our lives and lifting
household tasks above the commonplace.
For these opportunities I am grateful.
I am also thankful for the courage of
yesterday, the hope of tomorrow,
and a growing consciousness
of God's love always.

THURSDAY, MAY 14, 2026

Awards Luncheon in Patterson Ballroom—Level B 11:30 a.m.—1:30 p.m.

Presiding
Ann Porter, KEHA 1st Vice President

LUNCH

Inspirational Thought
Connie Vaughn, Bluegrass Area President

Greetings from Extension
Dr. Jennifer Hunter, Associate Dean for Extension and
Director of the Kentucky Cooperative Extension Service,
UK Martin-Gatton College of Agriculture, Food and Environment

Greetings from the Lieutenant Governor
Lt. Gov. Jacqueline Coleman

AWARDS PRESENTATIONS—KEHA Awards & Contest Winners
Membership/Grants—Martha Colley, 2nd Vice President
International—Tammy Alford, State Chairperson
Family & Individual Development—Amelia Godfrey, State Chairperson
Cultural Arts & Heritage—Cindy Moore, State Chairperson
Food, Nutrition & Health—Esther Bailey, State Chairperson
4-H Youth Development—Peggy Tracy, State Chairperson
Leadership Development—Cyndy Humble, State Chairperson

Invitation to 2027 State Meeting
Mechele Arnold, Green River Area President
May 4-6, 2027
Owensboro Convention Center, Owensboro, KY

Recognition of Outgoing Board Members
Henrietta Sheffel, KEHA President

Installation of Officers & Chairpeople
Henrietta Sheffel, President, and Karen Hill, Parliamentarian

Closing Remarks
Henrietta Sheffel, President

Reciting of the Creed (See page 10)

MEMBERSHIP AWARDS

Largest Percentage Membership Increase

1st Place—Robertson County 108%
2nd Place (tie)—Knott County 38%
2nd Place (tie)—McCreary County 38%
3rd Place—Perry County 31%

Largest Overall Increase in Membership

1st Place—Knott County, 45

***Golden Key Winner**

2nd Place—Barren County, 37
3rd Place—Taylor County, 34

Increase of 25 or More Members

Barren County
Campbell County
Franklin County
Knott County
Taylor County

3-Rs—Keys to Membership Campaign

\$100 drawings

Each time a county gets three new members (above the previous year total), the county will be entered into a drawing.

For Membership Tenure Recognitions, See page 15.

KEHA GRANT AWARDS

KEHA Development Grant Awards

Fort Harrod Area, Franklin County—

Making Smiles One Craft at a Time, \$500

Licking River Area, Mason County—

Helping Senior Citizens Mental Health, \$300

Mammoth Cave Area, Edmonson

County—The Homemaker Craft Circle, \$300

Northeast Area, Johnson County—

Leadership Toolbox—Growing Leaders for Tomorrow, \$400

INTERNATIONAL AWARDS

International Projects and Programs

1st Place—Barren County
2nd Place—Edmonson County
3rd Place—Clark County

Coins for Change

1st Place—Meade County \$843.08

2nd Place—Mason County \$714.36

3rd Place—Monroe County \$459.01

Kentucky Academy/Ghana Library

1st Place—Harrison County \$133.74
2nd Place—Pendleton County \$94.00
3rd Place—Anderson County \$77.69

FAMILY & INDIVIDUAL DEVELOPMENT AWARDS

Self-Care Contest

1st Place—Barren County, Cynthia Rowland/Club

THURSDAY, MAY 14, 2026

CULTURAL ARTS & HERITAGE AWARDS

Poetry

- 1st Place— *Captured Love in a Mason Jar* by Marie Stier Cavanah, Henderson County
2nd Place— *Old* by Kimberly Corbin, Taylor County
3rd Place— *Surrender* by Evelyn Adams, Calloway County

Memoirs

- 1st Place— *What the Green Glasses Taught Me* by Shelby Butler, Breckenridge County
2nd Place— *Winding Bobbins* by M.D. Llewellyn, Woodford County
3rd Place— *Hatchet Man* by Retha Hunt, Pike County

Short Stories

- 1st Place— *Crashing the Ceiling: An Adventure with Nora and Nana* by Monica Lucas, Meade County
2nd Place— *Cafeteria Lady* by M.D. Llewellyn, Woodford County
3rd Place— *Hornworm Mafia* by Jan Boaz, McCracken County

Passport County Winners

- 1st Place— Green County
2nd Place— Grayson County
3rd Place— Pendleton County

FOOD, NUTRITION & HEALTH AWARDS

Let No Child or Senior Go Hungry

- 1st Place - Edmonson County, Tammy Sanders
2nd Place— Barren County, Cynthia Rowland
3rd Place— Allen County, Jennifer Woods

Food Culture in Other Countries

- 1st Place - Taylor County, Debbie Holt
2nd Place— Barren County, Cynthia Rowland
3rd Place— Clark County, Wanda McCord

4-H YOUTH DEVELOPMENT AWARDS

Most Innovative 4-H/Homemaker Partnership Project

- 1st Place—Mason County, Helping to Make the Best Better Country Ham Project
2nd Place—Edmonson County, Blessing Box Project
3rd Place—Metcalfe County, Project Patriot

Most Volunteer Hours with 4-H Award

- 1st Place—Mason County, 1,542
2nd Place—Bourbon County, 972
3rd Place—Franklin County, 690

4-H Camp Scholarship Largest Donation Award

- 1st Place—Greenup County, \$2,800.00
2nd Place—Mason County, \$2,189.00
3rd Place—Edmonson County, \$1,000.00

4-H Camp Scholarship Largest Donation Amount for Club

- 1st Place—Trammell Creek Homemakers Club, Mammoth Cave Area, \$694.00

LEADERSHIP DEVELOPMENT AWARDS

Community Volunteerism Awards

- 1st Place—Pendleton County, Stuffies—Making Stuffie Gowns for the Cincinnati Children's Hospital
2nd Place—Edmonson County, Dinner Theatre for a Cause—Funding Trauma Kits for Local School
3rd Place—Larue County, Upgrade Floral Hall Exhibit Building at the Fairgrounds

Evans/Hansen/Weldon Scholarship

(No entries)

KEHA Member Scholarship

Caitlyn Kirby, Rockcastle County

Contributions to Evans/Hansen/Weldon Scholarship

- 1st Place— Fayette County, \$1,000
2nd Place— Meade County, \$200

Contributions to Homemaker Member Scholarship

- 1st Place— Bluegrass Area, \$1,141.00
2nd Place— Boyle County, \$162.82
3rd Place— Boyd County, \$25.00

Highest Amount in Local County Scholarships Awarded

- 1st Place— Hardin, \$16,150.00
2nd Place—Mason, \$5,500.00
3rd Place—Taylor, \$3,000.00

VSUS – VOLUNTEER SERVICE RECOGNITIONS

Top KEHA Hours

- 1st Place— Brenda Hammons of Fort Harrod Area, 2,435
2nd Place— Carolyn Hast of Purchase Area, 2,026
3rd Place— Vickie Jost of Purchase Area, 1,621

Top Extension Hours

- 1st Place— Lisa Ison of Quicksand Area, 2,099
2nd Place— Violet Barbee of Licking River Area, 1,903
3rd Place— Beulah Ross of Licking River Area, 1,212

Top Community Hours

- 1st Place— Diana Morgan of Northern KY Area, 5,198
2nd Place— Michelle Padgett of Fort Harrod Area, 2,625
3rd Place— Mary Lou Hester of Pennyryle Area, 2,612

Top Personal Hours

- 1st Place— Regina Wurth of Purchase Area, 7,874
2nd Place— Edwina Turner of Purchase Area, 7,521
3rd Place— Lana Sumner of Lake Cumberland Area, 4,684

ENVIRONMENT, HOUSING, & ENERGY AWARDS

Adopt-A-Highway Awards

(No Entries)



**CONGRATULATIONS
TO ALL OUR WINNERS!**



KEHA STATE BOARD

Kentucky Extension Homemaker Association 2025-2026 State Board

Officers

President Henrietta Sheffel, Breathitt County
 1st Vice President for Program Ann Porter, Mason County
 2nd Vice President for Member Resources..... Martha Colley, Christian County
 Secretary..... Barbara Seiter, Boone County
 Treasurer Patsy Kinman, Grant County

Educational Chairmen

Cultural Arts and Heritage Cindy Moore, Henry County
 Environment, Housing and Energy Rhonella Chaffin, Lawrence County
 Family and Individual Development..... Amelia Godfrey, Johnson County
 Food, Nutrition and Health Esther Bailey, Lincoln County
 4-H Youth Development..... Peggy Tracy, Bourbon County
 International..... Tammy Alford, Butler County
 Leadership Development Cyndy Humble, Taylor County
 Management and Safety Diana Morgan, Grant County
 Marketing and Public Relations Chairman Sharon Fields, Greenup County

Area Homemaker Presidents

PURCHASE Sandra Lusk, Fulton County
 PENNYRILE Brandy Garcia, Muhlenberg County
 GREEN RIVER Mechele Arnold, McLean County
 MAMMOTH CAVE..... Sandra Lennon, Logan County
 LAKE CUMBERLAND..... Mary Lynn Chaudoin, Green County
 LINCOLN TRAIL..... Jean Aull, Breckinridge County
 LOUISVILLE..... Barbara Payne, Jefferson County
 NORTHERN KENTUCKY Judy Jackson, Grant County
 FORT HARROD Leoni Mundelius, Lincoln County
 BLUEGRASS..... Connie Vaughn, Bourbon County
 LICKING RIVER Connie Bowling, Bracken County
 NORTHEAST Catherine Sparks, Johnson County
 QUICKSAND Anita Noble, Perry County
 WILDERNESS TRAIL..... DeRhonda Hubbs, Knox County

Other (Non-Voting Board Members)

Parliamentarian Karen Hill, Henderson County
 Master Farm Homemakers Guild Susan Hansford, Pulaski County
 KEAFCS..... Cabrina Buckman, Washington County
 KEHA Advisor Kelly May
 Assistant Director, FCS Extension Dr. Heather Norman-Burgdolf

University of Kentucky Advisors to State Educational Chairmen (Non-Board)

Cultural Arts and Heritage Jeanne Badgett
 Environment, Housing and Energy Tryone Atkinson
 Family and Individual Development..... Dr. Natese Dockery
 Food, Nutrition and Health Dr. Heather Norman-Burgdolf
 4-H Youth Development..... Dr. Kim Schrader
 International..... Leslie Frame
 Leadership Development Sally Mineer
 Management and Safety Dr. Monica Mundy
 Marketing and Public Relations..... Mindy McCulley
 Master Farm Homemakers Guild Sarah Hanks

KEHA Presidents

1932-33 * Mrs. Lyda Lynch Hall, Fayette County
 1934-35 * Mrs. W.M. Oliver, McCracken County
 1936-38 * Mrs. T.M. Johnston, Warren County
 1939-41 * Mrs. H.L. Crafton, Henderson County
 1941-43 * Mrs. P.W. Adkins, Bell County
 1943-45 * Mrs. Ralph Searce, Shelby County
 1945-46 * Mrs. W.E. Nichols, Fayette County
 1946-49 * Mrs. W.K. Morris, Christian County
 1950-53 * Mrs. Wade Hold, Nelson County
 1953-56 * Mrs. R. Matchett, Kenton County
 1956-59 * Mrs. Virgil Grayson, Pulaski County
 1959-62 * Mrs. Carl Evans, Ballard County
 1962-65 * Mrs. Harry J. Braun, Campbell County
 1965-68 * Mrs. James T. Brookshire, Breckinridge County
 1968-71 * Mrs. Earl Friedly, Scott County
 1971-74 * Mrs. Howard Taylor, Harrison County
 1974-77 * Mrs. Mitchell Bertram, Barren County
 1977-80 * Mrs. Samuel Whitt, Jr., Boyd County
 1980-83 * Mrs. James Wallace, Caldwell County
 1983-86 * Mrs. M.D. Perkins, Campbell County
 1986-89 * Mrs. L.E. Moorhead, Bracken County
 1989-92 * Helen Palmer, Clark County
 1992-95 Jean Davis, Hardin County
 1995-98 Velma Koostra, Warren County
 1998-2001 * Kathleen Hockersmith, Oldham County
 2001-04 * Mabel Harned, Nelson County
 2004-07 * René Siria, Franklin County
 2007-10 Linda Kaletch, McCracken County
 2010-13 Alice Brown, Greenup County
 2013-16 Susan Hansford, Pulaski County
 2016-17 * Mary Margaret Krahulec, Shelby County
 2017-19 Marlene McComas, Grant County
 2019-22 Karen Hill, Henderson County
 2022-25 Brenda Hammons, Lincoln County
 2022-Present Henrietta Sheffel, Breathitt County

* Deceased

UK FAMILY AND CONSUMER SCIENCES AGENTS

Adair – Dylan Gentry
Allen – Nan Montgomery
Anderson – Vacant
Ballard – Vacant
Barren – Jordan Crain
Bath – Alexandra Sallie
Bell – Rebecca Miller
Boone – Diane Mason
Bourbon – Kay Denniston
Boyd – Jacqueline Doucet
Boyle – Vacant
Bracken – Shannon Smith
Breathitt – Kelsey Sebastian
Breckinridge – Lynnette Allen
Bullitt – Ruth Chowning
Butler – Leah VanMeter
Caldwell – Ashley Board
Calloway – Debra Hixon
Campbell – Kate Thompson
Carlisle – Brooke Hogancamp
Carroll – Christy Eastwood
Carter – Whitney Morrow
Casey – Meagan Foust
Christian – Sarah Drysdale
Clark – Shonda Johnston
Clay – Brandy Napier
Clinton – Christy Stearns
Crittenden – Leslea Barnes
Cumberland – Debbie Messenger
Daviess – Katie Alexander
Edmonson – Laura-Grace Vincent
Elliott – Mandi Broderick
Estill – Judy Vaughn
Fayette – Maranda Brooks
Fayette – Caroline McMahan
Fleming – Katie Fryman
Floyd – Andi Slone
Franklin – Carla Carter
Fulton – Anna Morgan
Gallatin – Ronda Rex
Garrard – Kayla Lunsford
Grant – Asa Conkwright
Graves – Denise Wooley
Grayson – Natalie Taul
Green – Katelyn Squires
Greenup – Lora Pullin
Hancock – Lisa Hagman
Hardin – Dayna Fentress
Harlan – Vacant
Harrison – Shelley Meyer
Hart – Sonya Carter
Henderson – Tracie Etensohn
Henry – Krista Perry
Hickman – Mike Keller
Hopkins – Amanda Dame
Jackson – Delaney Eubanks
Jefferson – Vacant
Jessamine – Sara Haag
Johnson – Macey Stewart
Kenton – Joan Bowling
Kenton – Denise Donahue
Knott – Stacy Trent
Knox – Kelsee Dewees
LaRue – Marla Stillwell
Laurel – Lora Davidson
Lawrence – Deana West
Lee – Laken Campbell
Leslie – Vicki Boggs
Letcher – Nanette Banks
Lewis – Christa O’Cull
Lincoln – Jody Paver
Livingston – Joni Phelps
Logan – Rachel Hance
Lyon – Angie York
Madison – Jessica Hunley
Magoffin – Kayla Shepherd
Marion – Rachel Mattingly
Marshall – Vicki Wynn
Martin – Vacant
Mason – Abbigale Yazell
McCracken – Kelly Alsip
McCreary – Amy Singleton
McLean – Abigail Emmons
Meade – Jennifer Bridge
Menifee – Vacant
Mercer – Tara Duty
Metcalfe – Lynn Blankenship
Monroe – Stephanie Hestand
Montgomery – Sarah Congleton
Morgan – Kimberly Lane
Muhlenberg – Katie Elkins
Nelson – Danielle Hagler
Nicholas – Ashley Vice
Ohio – Kelly Bland
Oldham – Heather Toombs
Owen – Andrea Wilde
Owsley – Crystal Osborne
Pendleton – Kenna Knight
Perry – Lorie Adams
Pike – Chelsea Workman
Powell – Kendyl Redding
Pulaski – Edith Lovett
Robertson – Britney Poe
Rockcastle – Vacant
Rowan – Peggy Jones
Russell – Megan Gullett
Scott – Alivia Stevens
Shelby – Elizabeth Coots
Simpson – Nancy Doyle
Spencer – Beth Maxedon
Taylor – Kimberly Hope-Thomas
Todd – Jill Harris
Trigg – Shelley Crawford
Trimble – Jane Proctor
Union – Shea Heady
Warren – Brandalyn Reddick
Washington – Cabrina Buckman
Wayne – Debbie Shepherd
Webster – Briana Alvey
Whitley – Linda Burgard
Wolfe – Robert Warren
Woodford – Hannah Sturgill

KSU FAMILY AND CONSUMER SCIENCES AGENTS

Anderson, Fayette, Franklin – Kennedy Hannah
Crittenden – Rebecca Woodall
Hancock – Angie Swihart

Trigg – Chelsea Redd
KSU West Regional Center – Kim Harriford
KSU West Regional Center – Megan Treadway

EXTENSION DIRECTORS

Regional Extension Directors

East Region
Extension Director
Daniel O. Wilson

Central Region
Extension Director
Natasha Lucas

West Region
Extension Director
Jeremy Teal

Assistant Region Director
Ty Back

Area Extension Directors

East Region
Jeffrey H. Casada, East 1&2
Judi O'Bryan, East 3&4
Dora Centers, East 5&6
Raven Ford, East 7&8

Central Region
Kayla Watts, Central 1&2
Rita Stewart, Central 3&4
Willie Howard, Central 5&6
Christin Herbst, Central 7&8

West Region
Robert C. Tashjian, West 1&2
Matt Fulkerson, West 3&4
Amanda Hardy, West 5&6
Amber Huffman, West 7&8

KEHA MEMBERSHIP TENURE RECOGNITIONS

50 Years of Service

Suzette Bailey
Connie Bowling
Jackie Courts
Retha Crail
Irene Evans
Nancy Faulkner
Mary Agnes "Aggie" Fink
Charlinda Fugate
Patti Gableman
Linda Heflin
Freda Hicks
Geri Howard
Jean Huff
Janet Sharon Huff
Gypsy Jones
Jeannie Lancaster
Charlotte Lucus
Zenette Newsome
Peggy Otis

Linda Padgett
Mary Lois Roberts
Mary Sargent
Virginia Stallin
Carol Stine
Janice Gail Stone
Linda Thompson
Alice Walker
Janet Whaley
Vinita Winters

55 Years of Service

Peggy Adams
Lisa Boggs
Leona Cantrell
Harriett Haney
Helen Hayes
Sue Tackett
Sonja Whittle

60 Years of Service

Sherry Boyd
Delores Brown
Mary Ceason
Annie Laura Ferris
Janet Geiske
Dorothy Harris
Nancy Hudson
JoAnn Hughes
Gay Kirby
JoAnn Pawsatt
Nancy Pratt
Imogene Updike

65 Years of Service

Stella Barnett
Ruby Bryce
Dottie Gray
Sara Gray
Nellie Houchins

Virginia Johnson
Millie Pitkas
Janet Van Bibber

70 Years of Service

Katherine Dunn
Jean Fenwick
Ruth Stevens
Shirley Whitlow

75 Years of Service

Margie Morgan Applegate
Marie Courts
Helen Yonce

Stay in the Loop!!

Visit the NEW and improved KEHA website at www.keha.org.

Like and follow KEHA on Facebook at
www.facebook.com/OfficialKEHA.

Watch for the monthly KEHA News & Notes on the website.



TRADE SHOW

Our 2026 Trade Show has expanded! Visit vendors in two locations—downstairs on Level B in the Patterson Ballroom Pre-Function AND on the lobby level in the Regency Pre-Function.

Patterson Pre-Function—Level B

- ◇ KEHA Merchandise
- ◇ The Silver Lady
- ◇ Dandelion D
- ◇ Sherry A. Burton, Author
- ◇ Scott's Workshop
- ◇ Sun Sugar Farms/CRESBI Crates
- ◇ Stitchin' 4 U
- ◇ Linda's Pearls and Oysters
- ◇ Follow the Star Boutique
- ◇ EAR TIERS LLC
- ◇ Silver Treasures Designs
- ◇ Hatfield Paper Crafts
- ◇ Arts on Main
- ◇ Sinister Handed Works
- ◇ The Hobbye Shoppe

Regency Pre-Function—Lobby Level

- ◇ Kentucky CASA Network
- ◇ Ovarian Awareness of Kentucky (O.A.K.)
- ◇ Blacksferry Handmade Baskets
- ◇ Willow & Bead Co & Burning Bush Candles

We extend sincere thanks to all of the vendors at our 2026 Trade Show.

PHOTO BOOTH: A KEHA photo booth has been set up for general use in the hotel lobby, such as for selfies or group photos. Share your best conference photos with KEHA's Marketing & Publicity Chairperson Sharon Fields, and they might get highlighted online! Text is preferred at 606-922-6229 or email scrawford@kih.net.

EVALUATION



- Please complete a KEHA State Meeting evaluation! Chose **one** of the following ways to share your thoughts:
- Scan the QR Code
 - Visit <https://bit.ly/2026KEHASurvey>
 - OR turn in a paper copy at the banquet podium or registration desk

SAVE THE DATE

Make plans to attend the
2027 State Meeting

Owensboro Convention Center
Owensboro, KY

May 4-6, 2027

Green River Area will serve as the host area.

Check the KEHA website (www.keha.org) this summer for lodging rates and details.

